

Single Phase 0.8Amp Glass passivated Bridge Rectifiers

MB05F~MB10F
50 to 1000 V
0.8A
MBF

Features

- u The plastic package carries Underwriters Laboratory Flammability Classification 94V-0
- u Ideal for printed circuit board
- u Glass passivated Junction chip
- u Low reverse leakage
- u High forward surge current capability
- u High temperature soldering guaranteed 250 °C /10 seconds at terminals

Mechanical Data

- u Case: Molded plastic body
- u Terminals: Solder plated, solderable per MIL-STD-750, Method 2026
- u Polarity: Polarity symbol marking on body
- u Mounting Position: Any
- u Weight : 0.004 ounce, 0.1 grams

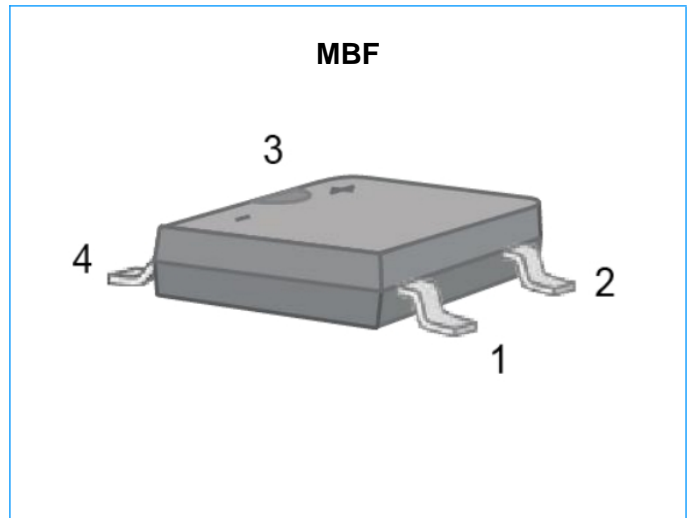

Maximum Ratings and Electrical Characteristics

Ratings at 25°C ambient temperature unless otherwise specified. Single phase half-wave 60Hz, resistive or inductive load, for capacitive load current derate by 20%.

Parameter		Symbol	MB05F	MB1F	MB2F	MB4F	MB6F	MB8F	MB10F	Units
Maximum Repetitive Peak Reverse Voltage		V_{RRM}	50	100	200	400	600	800	1000	V
Maximum RMS Voltage		V_{RMS}	35	70	140	280	420	560	700	V
Maximum DC Blocking Voltage		V_{DC}	50	100	200	400	600	800	1000	V
Maximum Average Forward Rectified Current at $T_L=30^\circ\text{C}$	On glass-epoxy P.C.B (Note 1)	$I_{(AV)}$	0.8							A
	On aluminum substrate (Note 2)		1							
Peak Forward Surge Current : 8.3ms Single Half Sinewave Superimposed on Rated Load (JEDEC Method)		I_{FSM}	35							A
Maximum Instantaneous Forward Voltage at 0.8A		V_F	1							V
Maximum DC reverse current at rated DC blocking voltage	$T_A=25^\circ\text{C}$	I_R	5							μA
	$T_A=125^\circ\text{C}$		500							
Typical junction capacitance (Note 3)		C_J	13							pF
Typical Thermal Resistance		$R_{\theta JA}$	65							$^\circ\text{C/W}$
Operating Junction and Storage Temperature Range		T_J, T_{STG}	-55 to +150							$^\circ\text{C}$

- Notes:**
1. Mounted on glass epoxy PC board with 1.3*1.3mm solder pad.
 2. Mounted on aluminum substrate PC board with 1.3*1.3mm solder pad.
 3. Measured at 1MHz and applied reverse voltage of 4.0V D.C.

Single Phase 0.8Amp Glass passivated Bridge Rectifiers

MB05F~MB10F
50 to 1000 V
0.8A
MBF

Rating and Characteristic Curves

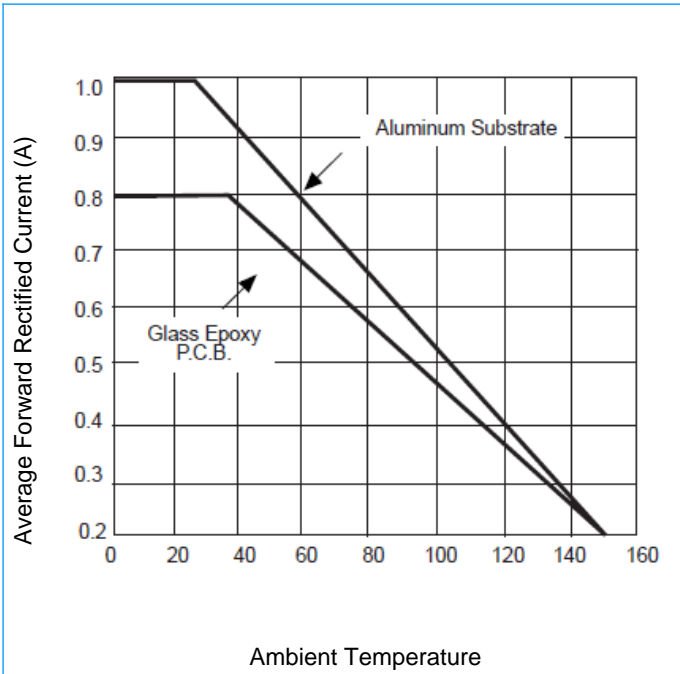
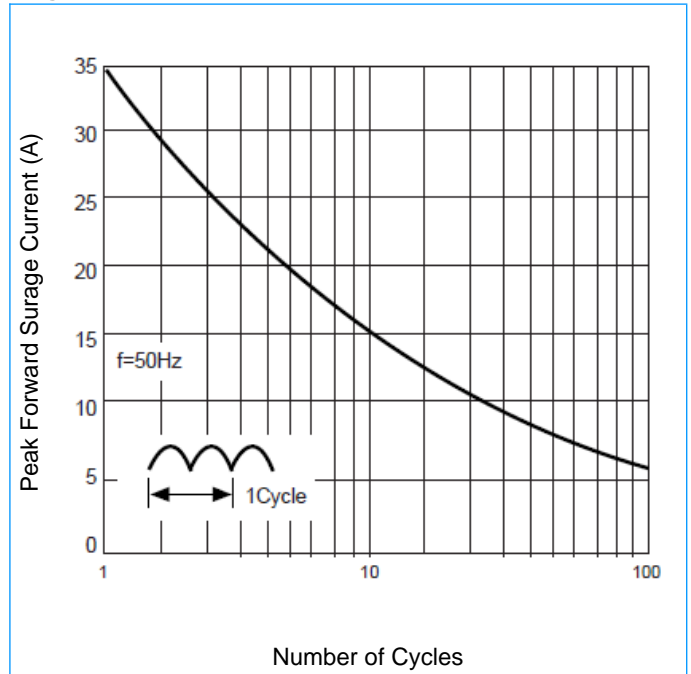
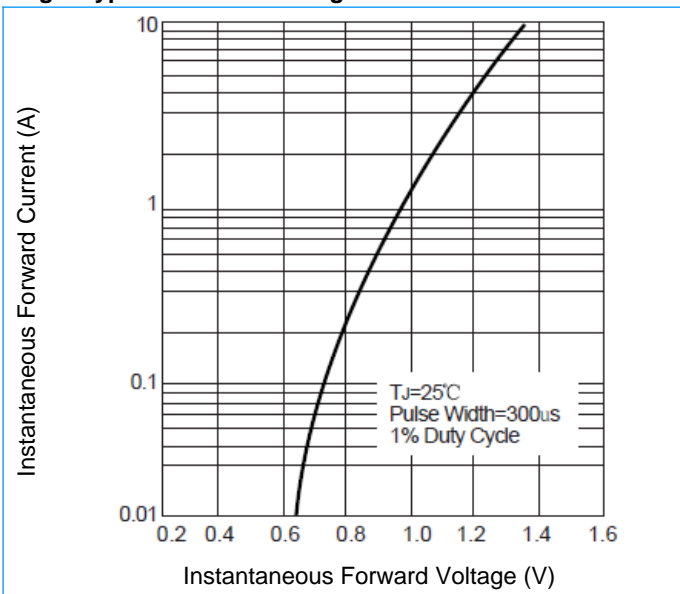
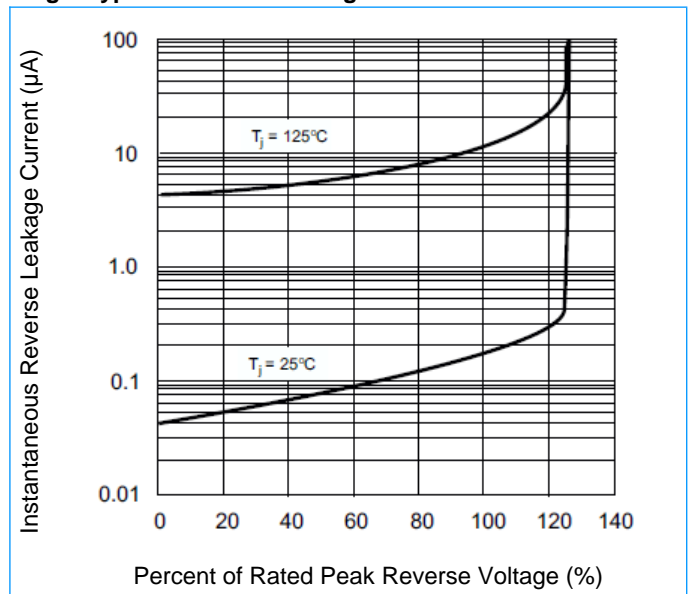
Fig1. Derating Curve Output Rectified Current

Fig2. Maximum Non-repetitive Peak Forward Surge Current

Fig3. Typical Forward Voltage Characteristics

Fig4. Typical Reverse Leakage Characteristics

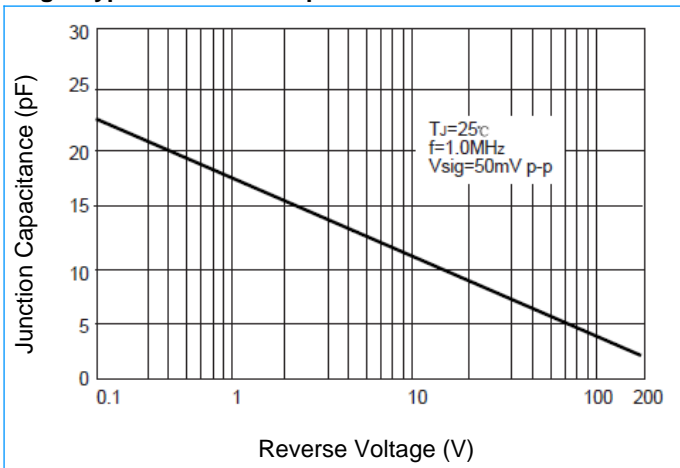
Single Phase 0.8Amp Glass passivated Bridge Rectifiers

MB05F~MB10F
50 to 1000 V
0.8A
MBF

Rating and Characteristic Curves (Continue)

Fig5. Typical Junction Capacitance

MBF Package Outline (Dimensions in inches and (millimeters))

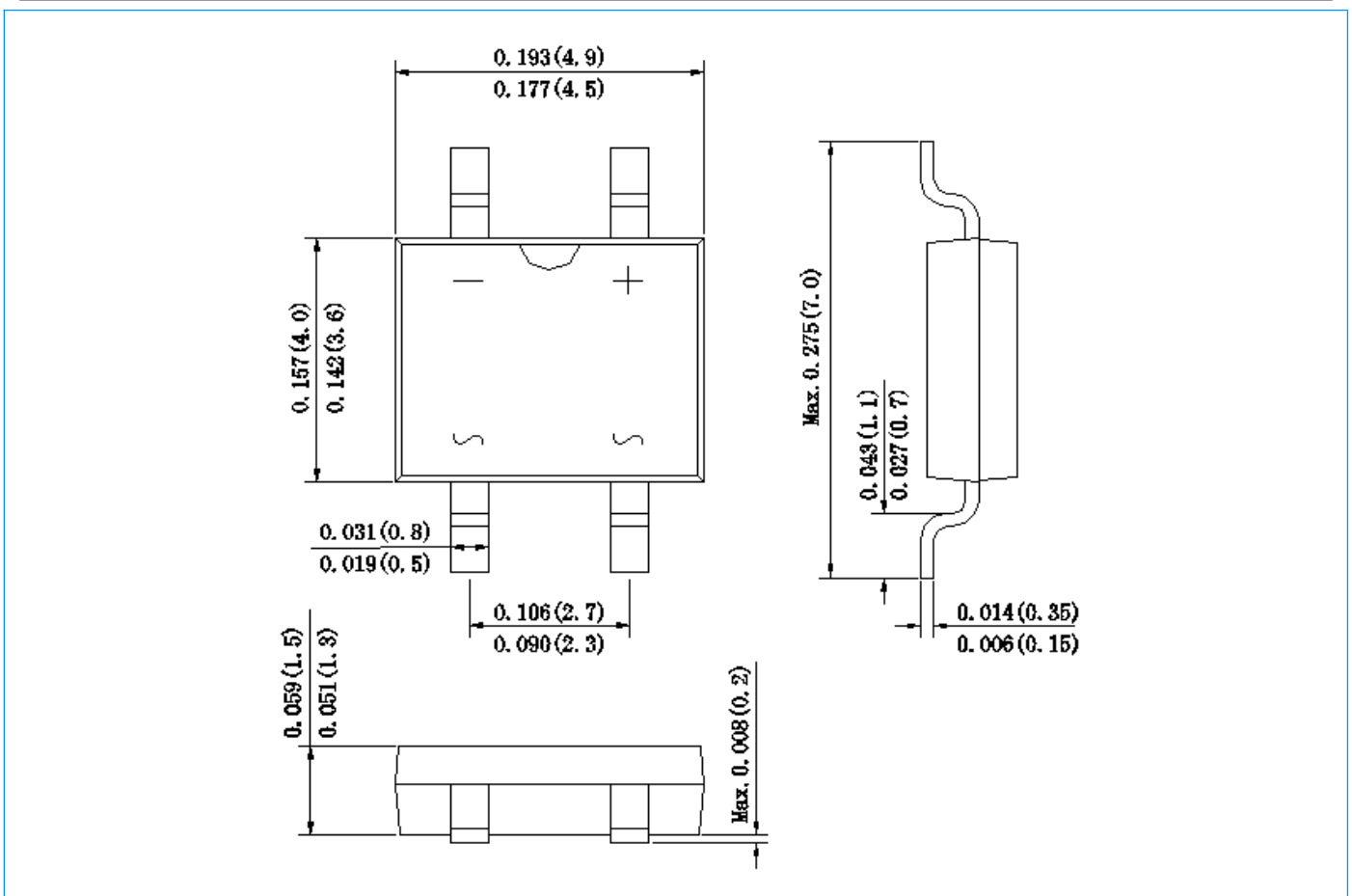

Single Phase 0.8Amp Glass passivated Bridge Rectifiers**MB05F~MB10F****50 to 1000 V****0.8A****MBF****Packaging Information**

Part Number	Component Package	Quantity
MB05F~MB10F	MBF	3000 PCS